

**CERTIFICATE OF APPROPRIATENESS**

**Application Date:** August 8, 2022

**Applicant:** Nicholas Lappin, agent for, Mark Lappin, owner

**Property:** 518 W 13th Street, E 69.2 ft of Lots 34, 35, & 36, Block 182, of Houston Heights Subdivision. The property includes a historic 1,592 square foot one-story bungalow single-family residence situated on a 6,920 square foot interior lot.

**Significance:** Contributing bungalow residence, constructed circa 1920, with a carport and located in the Houston Heights West Historic District. Received previous approved COAs for rear addition and remove asbestos siding and restore original wood siding underneath on original historic structure in March 2022.

**Proposal:** Alteration - Roof

- Replace composition shingles on roofs of historic structure and rear addition with standing seam metal
- No change in the structure, shape, or pitch of the roofs
- **Information Subject to Change Before Final Report**

**Public Comment:** No public comment received.

**Civic Association:** No comment received.

**Recommendation:** Approval

**HAHC Action:** -

**APPROVAL CRITERIA****ALTERATIONS, REHABILITATIONS, RESTORATIONS AND ADDITIONS**

Sec. 33-241: HAHC shall issue a certificate of appropriateness for the alteration, rehabilitation, restoration or addition of an exterior feature of (i) any landmark, (ii) protected landmark, (iii) any building, structure or object that is part of an archaeological site, or (iv) contributing building in a historic district upon finding that the application satisfies the following criteria, as applicable:

- | <b>S</b>                            | <b>D</b>                            | <b>NA</b>                           | <b>S - satisfies</b> | <b>D - does not satisfy</b> | <b>NA - not applicable</b> |
|-------------------------------------|-------------------------------------|-------------------------------------|----------------------|-----------------------------|----------------------------|
| <input checked="" type="checkbox"/> | <input type="checkbox"/>            | <input type="checkbox"/>            |                      |                             |                            |
|                                     | <input checked="" type="checkbox"/> | <input type="checkbox"/>            |                      |                             |                            |
|                                     | <input type="checkbox"/>            | <input checked="" type="checkbox"/> |                      |                             |                            |
| <input checked="" type="checkbox"/> | <input type="checkbox"/>            | <input type="checkbox"/>            |                      |                             |                            |
| <input checked="" type="checkbox"/> | <input type="checkbox"/>            | <input type="checkbox"/>            |                      |                             |                            |
| <input checked="" type="checkbox"/> | <input type="checkbox"/>            | <input type="checkbox"/>            |                      |                             |                            |
| <input checked="" type="checkbox"/> | <input type="checkbox"/>            | <input type="checkbox"/>            |                      |                             |                            |
| <input checked="" type="checkbox"/> | <input type="checkbox"/>            | <input type="checkbox"/>            |                      |                             |                            |
| <input checked="" type="checkbox"/> | <input type="checkbox"/>            | <input type="checkbox"/>            |                      |                             |                            |
| <input checked="" type="checkbox"/> | <input type="checkbox"/>            | <input type="checkbox"/>            |                      |                             |                            |
| <input checked="" type="checkbox"/> | <input type="checkbox"/>            | <input type="checkbox"/>            |                      |                             |                            |
| <input checked="" type="checkbox"/> | <input type="checkbox"/>            | <input type="checkbox"/>            |                      |                             |                            |
| <input checked="" type="checkbox"/> | <input type="checkbox"/>            | <input type="checkbox"/>            |                      |                             |                            |
| <input checked="" type="checkbox"/> | <input type="checkbox"/>            | <input type="checkbox"/>            |                      |                             |                            |
| <input type="checkbox"/>            | <input type="checkbox"/>            | <input checked="" type="checkbox"/> |                      |                             |                            |

**HEIGHTS DESIGN GUIDELINES**

- |                                     |                          |                          |  |  |  |
|-------------------------------------|--------------------------|--------------------------|--|--|--|
| <input checked="" type="checkbox"/> | <input type="checkbox"/> | <input type="checkbox"/> |  |  |  |
|-------------------------------------|--------------------------|--------------------------|--|--|--|
- In accordance with Sec. 33-276, the proposed activity must comply with the City Council approved Design Guidelines.

District Map



Inventory Photo



Current Photograph



Proposed Roof Plan with Standing Seam Metal

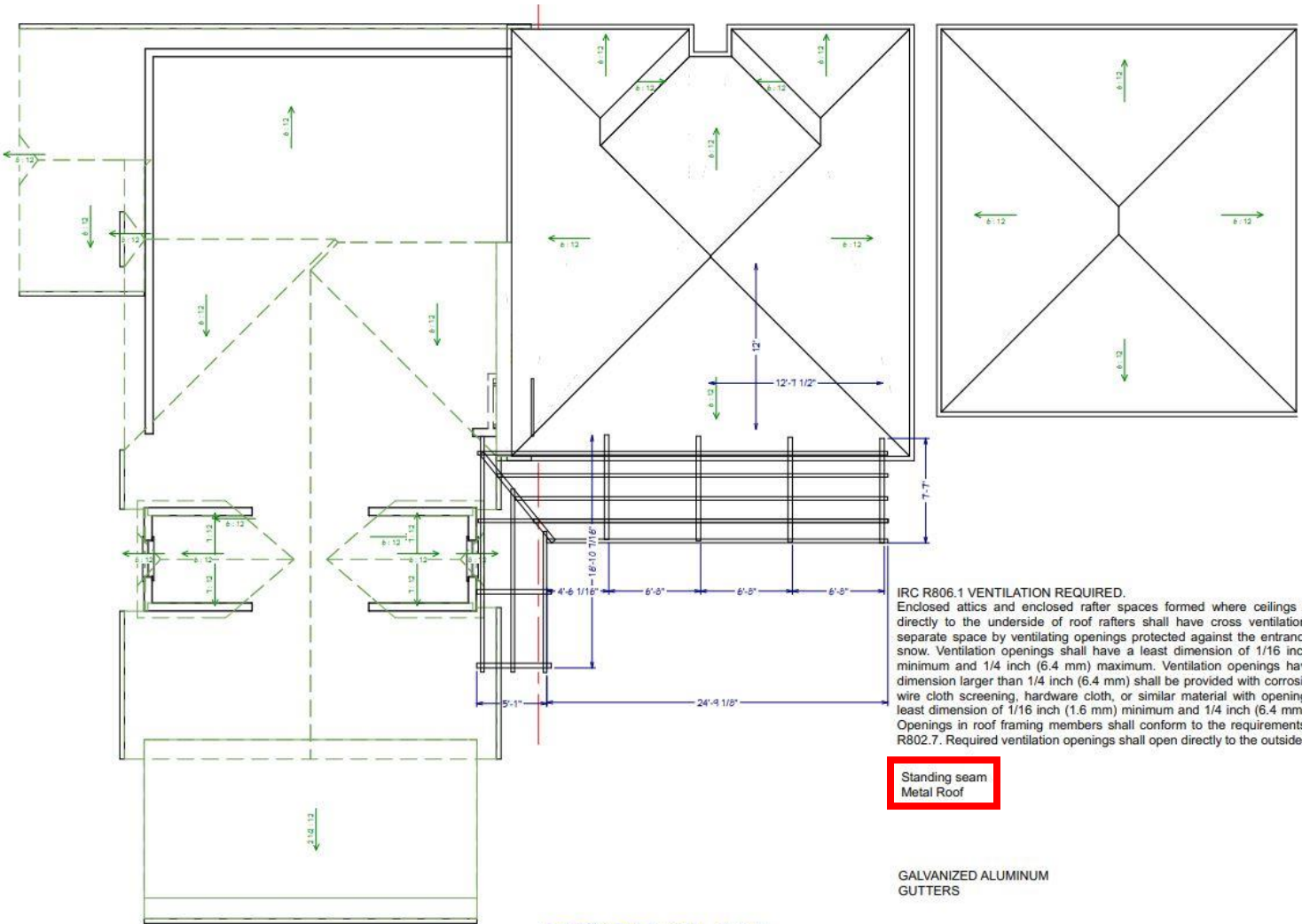

ROOF PLAN